

We are very pleased that you decided to purchase this product from SWAROVSKI OPTIK. If you have any questions, please consult your specialist dealer or contact us directly at **WWW.SWAROVSKIOPTIK.COM**.

- 1 Dioptic correction
- 2 Magnification adjustment ring
- 3 Screw-on cap
- 4 Elevation adjustment turret
 - 4.1. Zero point adjustment
- 5 Windage adjustment turret
 - 5.1. Zero point adjustment
- 6 Knurled knob
- 7 OFF/DAY/NIGHT switch
- 8 Brightness control for reticle illumination
- 9 Battery for reticle illumination
(button cell CR 2032)
- 10 Battery cover
- 11 Replacement battery box
- 12 Parallax turret (depending on model)
- 13 Protective cap
- 14 SWAROVSKI OPTIK Rail cover
- 15 Coin opener

Please find our current product accessories at **WWW.SWAROVSKIOPTIK.COM**.

Description

Z6/Z6i

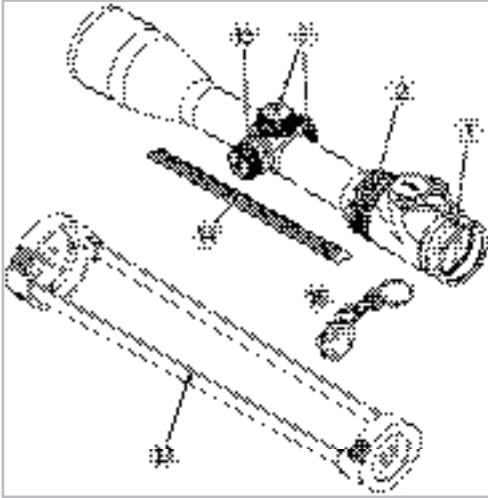

Reticle illumination

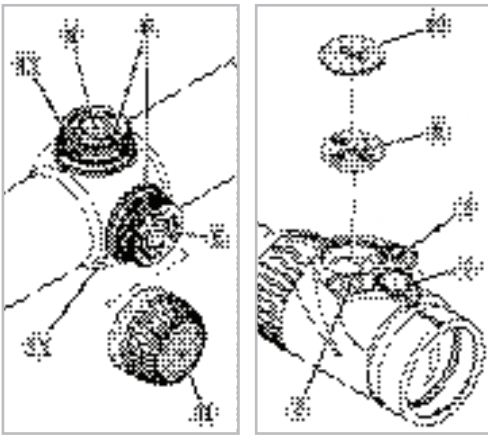

For your safety!

⚠ WARNING!

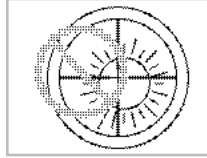

Never use the rifle scope to look at the sun! This will lead to damage to your eyes! Please protect your rifle scope from unnecessary solar radiation.



Please note the eye relief distance specified for a mounted rifle scope (see Data Sheet for dimensions).

General Information



Please protect your rifle scope against knocks.

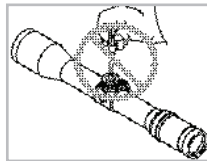

Repairs should only be carried out by authorized workshops.

Sealing

Thanks to the use of high-quality sealing elements and controlled fabrication processes, our rifle scopes are watertight and gas-tight to a pressure of 0.4 bar or a depth in water of 4.4 yds/4 m. Seal integrity is guaranteed even when the screw-on cap has been removed. Nevertheless, careful handling is advised, especially around the turrets.

The scope has been filled with nitrogen via the sealing screw located underneath the windage adjustment turret. Please do not loosen this sealing screw!

Mounting

Basic Alignment

To ensure perfect alignment of the scope to the rifle, please have a competent gunsmith mount the scope.

The reticle has been factory-set to the mechanical middle position. Prior to mounting you can check the correct position of the reticle. To do this, unscrew the screw-on caps of the elevation adjustment turret and windage adjustment turret.

Now turn the respective knurled knob of the elevation adjustment turret and windage adjustment turret clockwise until it reaches the stop. Then turn the knurled knob back again counter-clockwise until it reaches the stop and count the clicks at the same time.

Halve the number of clicks and you will have the exact middle position. Repeat this procedure for the second turret.

Alignment of the Scope to the Rifle

If the point of impact of the bullet deviates from the aiming point, this can be easily and precisely corrected by adjusting the elevation turret and the windage turret of the scope.

Regardless of corrections, the middle point of the aiming mark always stays in the middle of the field of view.

To make adjustments, simply unscrew the screw-on caps of the elevation and windage turrets.

When the shot is low

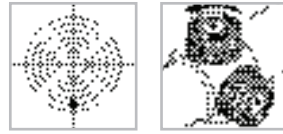

Turn the knurled knob of the elevation turret in the direction of H.

When the shot is high

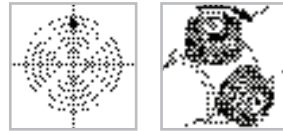

Turn the knurled knob of the elevation turret in the opposite direction to H.

When the shot is to the left

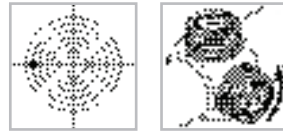

Turn the knurled knob of the windage turret in the direction of R.

When the shot is to the right

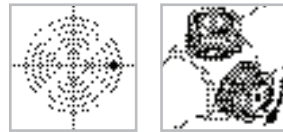

Turn the knurled knob of the windage turret in the opposite direction to R.

The impact point correction per click can be taken from the enclosed technical data sheet or the information printed on the elevation or windage adjustment turret of your rifle scope.

Zero Point Adjustment

Once you have aligned the scope to the rifle, you can retain this basic setting. The scale for this is located on the respective knurled knob of the elevation/windage adjustment turret.



1. Pull the knurled knob upwards. In this position the reticle is not adjusted when the knurled knob is twisted.

2. Turn the knurled knob until the zero point of the scale is aligned with the index point on the scope.
3. Pushing the knurled knob back down re-engages the reticle adjustment and the knurled knob. Your individual setting is now precisely adjusted as the zero point.

Operation

Adjusting the Focus

Simply turn the diopter correction ring to achieve the best focus for your individual setting of the reticle.



First turn the diopter correction ring all the way to the left ① (counter-clockwise) and then to the right ②, until the reticle is optimally focused.

The adjustment ranges depend on the individual models. Please consult the technical data sheet enclosed.

Changing the Magnification



You can set the desired magnification by turning the (stepless) magnification adjustment ring through 180°. The scale on the adjustment ring allows simple and easy reading of the setting.

The soft, ribbed covering of the adjustment ring has a nose for better orientation.

The Reticle in the 2nd Image Plane (Eyepiece Image Plane)



If the magnification increases, then the reticle remains the same size – the size of the image is increased but not the size of the reticle. Even for large magnifications only a little of the target is covered. The reticle can only be used for estimating the distance to a limited extent.

Parallax

Your rifle scope is set to be parallax-free without parallax turret at a target distance of 100 m – or in the case of the 4A-300, 4A-300-I, BR (only available in the USA) and BR-I reticles at a target distance of 200 m. This means that at a distance of 110 yards (100 m) and 219 yards (200 m) respectively, the image of the object aimed at and the image of the reticle are in a single plane.

Please take into consideration:

With shots at distances greater or less than 110 yards (100 m) and 219 yards (200 m) respectively, take care to position the eye carefully central to the scope. This will prevent shifting of the impact point due to parallax errors.

Operation of the Parallax Turret (depending on model)



Using the parallax turret, you can adjust the optimum focus for every target distance thus preventing aiming errors due to parallax.

a) Rapid Adjustment

The target distances are printed on the parallax turret from 55 yards (50 m) to ∞ . Turn the parallax turret until the index point indicates the desired distance.

b) Precision adjustment

Set the magnification as high as possible and turn the parallax turret until the image appears at its sharpest. Now move the eye backwards and forwards within the range of the exit pupil. If in the process the reticle moves in relation to the image, correct the distance setting until it is no longer possible to discern any difference between the movement of the reticle and the movement of the image.

Operation of the Reticle Illumination

1. OFF/DAY/NIGHT switch

First of all choose between daytime (symbol) and twilight (symbol) illumination by turning the switch to the appropriate position.



2. Brightness control



You can now adjust the brightness in the mode selected by means of the +/- button. To quickly find the optimum brightness, the button can remain pressed (sustained pulse). You can make fine adjustments

by pressing the buttons once (individual pulse).

3. Switching off



To do this, turn the OFF/DAY/NIGHT switch to the center position.

4. Memory function

When turning off the illumination unit, the last brightness setting used for DAY or NIGHT will be stored and automatically activated when the unit is turned on again.

5. Automatic turn-off function

The illumination of the unit automatically turns off if no brightness adjustment has been carried out within a period of 3 hours during the day or 5 hours at night.

6. Battery power indicator

If the illuminated reticle begins to flash, this signifies that a battery change will soon be needed. The remaining operating time will be a few hours, depending on the brightness adjustment and ambient temperature.

7. Changing the battery



- Turn off the reticle illumination.
- Please unscrew the battery compartment lid using the coin opener provided.
- Remove the old battery.



- When installing the new battery (type CR 2032) please make sure that the side marked “+” is facing upwards.
- Screw the battery cover back on.

Do not dispose of old batteries with domestic waste as they may contain toxic, environmentally harmful substances. Please take old batteries to a battery collection point to ensure proper recycling.

Please note!

The last brightness setting stored will be lost when the battery is changed.

8. Battery operating hours

Consult the technical data sheet enclosed!

9. Conformity

The reticle illumination unit complies with Directive No. 89/336/EC regarding electromagnetic compatibility.



Attach spare battery container

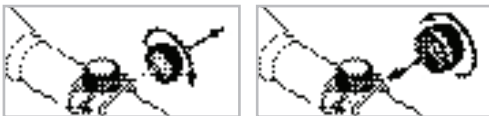

Battery



Covering the SWAROVSKI OPTIK Rail



The cover provided serves to protect the exposed rail parts. It may be cut to the required size and pressed into the rail by hand.

Maintenance and Care

Lens-Cleaning Cloth

The special microfibre cloth can be used to clean even the most sensitive glass surfaces. It is suitable for objective lens, eyepieces and spectacles.

Please keep the microfiber cloth clean as dirt particles can damage the lens surface. If the cloth is dirty, it may be washed in lukewarm soapy water and allowed to dry naturally. Please use it exclusively for cleaning lens surfaces.

Cleaning

We have designed all elements and surfaces to require very little care.

To ensure the long-lasting optical brilliance of your rifle scope, you should keep the glass surfaces free from dirt, oil and grease. When cleaning the lenses, first remove larger particles with an optical lens brush. For subsequent thorough cleaning, breathe lightly on the lens and clean with the cleaning cloth. The metal parts are best cleaned with a soft, clean cloth.

Storage

You should keep your rifle scope in a well-ventilated, dry, dark place.

If the rifle scope is wet, it must be dried prior to storage.

All details are typical values.

We reserve the right to make changes regarding design and delivery.
We accept no liability for printing errors. BA-670/1, 02/2009