

SLC

8x30 WB, 7x42 B, 10x42 WB, 7x50 B
8x50 B, 10x50 WB, 8x56 B, 15x56 WB



Instructions for use and care

SWAROVSKI OPTIK KG
6067 Absam · Austria
Tel. +43/5223/511-0 · Fax +43/5223/41 860
info@swarovskioptik.at
www.swarovskioptik.com
BA-643/3, 05/2007

SWAROVSKI
OPTIK

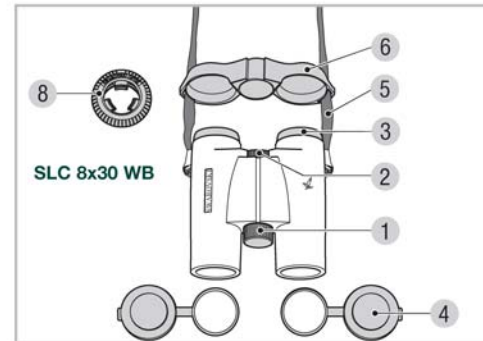

- | | |
|---------------------------------|---|
| 1 Focusing wheel | 5 Carry strap |
| 2 Dioptic correction wheel | 6 Rain protection cap |
| 3 Twist-in eye cups | 7 Covering for the tripod connection thread |
| 4 Protective objective lens cap | 8 Snap Shot Adapter |

Please find our current product accessories at www.swarovskioptik.com.

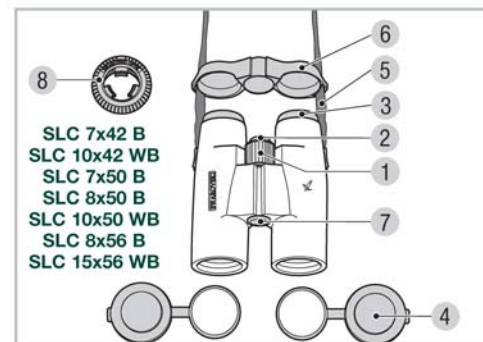

We are very pleased that you decided to purchase this product from *Swarovski Optik*. If you have any questions, please consult your specialist dealer or contact us directly at www.swarovskioptik.com.

For your safety!

⚠ WARNING!

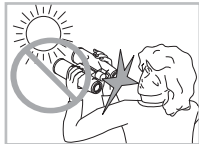

Never look at the sun with the binocular! This leads to injury of your eyes!



Never look through the binocular when walking! You could encounter obstacles!

General information

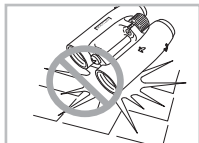

Please protect your binoculars from jolts and jars.



Repairs should be carried out only by authorized workshops.

Attaching the lift carrying strap

Attachment without pouch or use with pouch detached.

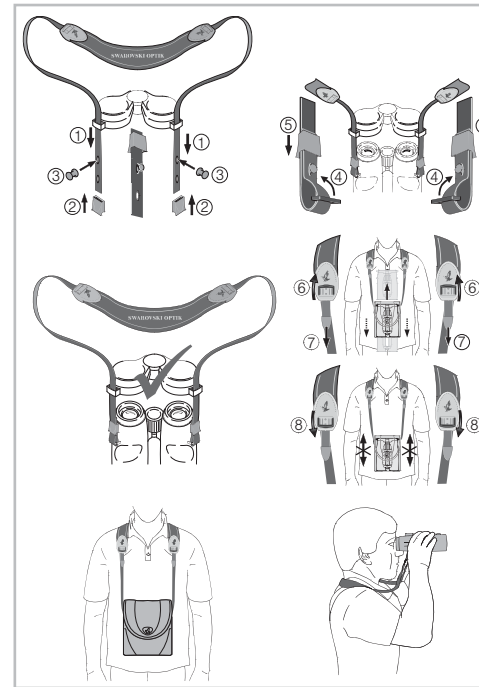

Attachment with pouch hooked in on one side.

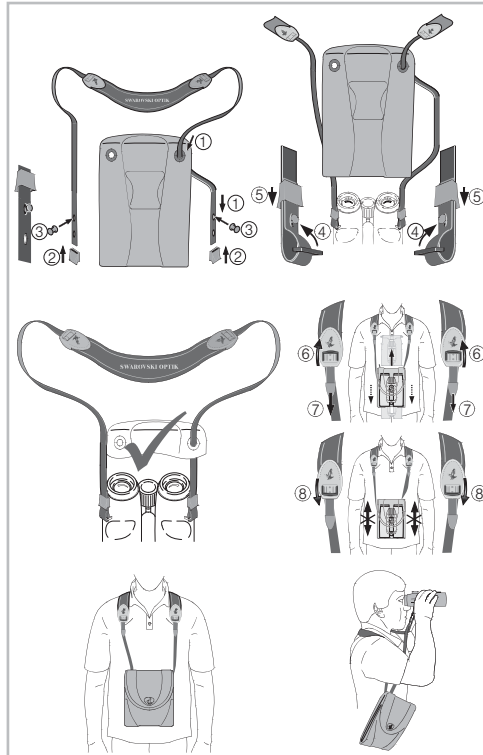

Operation

Adjustment of the screw-in-type eye cups

The screw-in-type eye cups have a fully variable adjustment to suit different eye or eyeglass positions. This enables you to adjust the distance between your eye or eyeglass and the ocular lens to suit your personal needs.

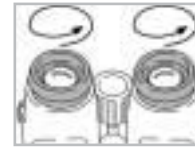

Use without eyeglasses:

Screw out both eye-cups (counter-clockwise) until you find the optimum position.

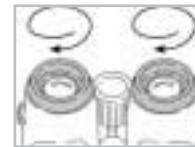

Use with eyeglasses:

Screw in both eye cups (clockwise) until you find the optimum position.

Adjustment of interpupillary distance

To see a single round image, turn the two halves of the binoculars until no irritating shadows can be seen.

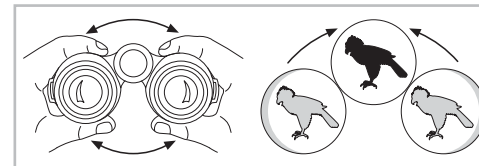

Adjustment of focusing

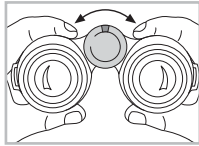

By turning the focusing wheel you can focus any object sharply at a distance of 4.4–9.9 yds (4–9 m) to infinity, depending on the type of binoculars.

In the infinity position the little nose of the focusing wheel is at the top (not available with SLC 8x30 WB).

Dioptric compensation

To achieve optimal image quality, the possibly varying visual acuity between the left and right eye must be corrected.

Use without eyeglasses and equal acuity of both eyes, or with eyeglasses:

Place the dioptric correction wheel in the middle position by simultaneously pressing and turning it.

Use without eyeglasses and varying acuity:

1. Look through the left ocular with your left eye and turn the focusing wheel to focus sharply on a selected object.
2. Now look at the same object through the right ocular with your right eye and again adjust the dioptric correction wheel to attain optimal clarity.

Both dioptric correction and focusing have been completed for your particular visual acuity. Please note down your personal dioptric setting – this can be read at the edge of the dioptric correction wheel.

Tripod connection

(not available with SLC 8x30 WB)

Unscrew the covering of the tripod connection thread by turning it to the left (anti-clockwise). To mount the binocular onto the tripod, you require the tripod connection which is available as an accessory. Regarding the SLC 15x56 WB, the connection pin is already mounted on the instrument.

Maintenance and Care

Lens-cleaning cloth

You can clean high sensitive lens surfaces with the enclosed special cloth made of micro-fibres. It is suitable for objective lens, ocular lens and eye-glasses.

Please keep the cloth clean, as dirt can damage the lens surface. If the cloth gets dirty, it can be washed in luke-warm soapy water and air-dried. Please use it exclusively for cleaning lens surfaces!

Cleaning

We have designed all elements and surfaces to require little care. To ensure the long-lasting

EN

optical brilliance of your binocular, you should keep the glass surfaces free of dirt, oil and grease. When cleaning the lenses, first remove larger particles with an optical lens brush. For the subsequent thorough cleaning we recommend breathing onto the lens surface to form a coat of condensation and then cleaning it with a soft, moist cloth.

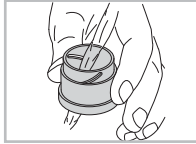

The housing is best cleansed with a soft, moist cloth (don't use the lens-cleaning cloth).

In the event of hard-to-remove dirt (e.g. sand), the eye-cup can be unscrewed. The ocular can then be cleaned easily.

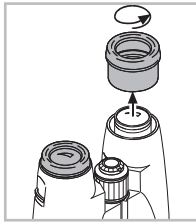

Storage

You should keep your binocular in its bag in a well-ventilated, dry place.



If the instrument is wet, it must be dried prior to storage.

In tropical regions or regions with a high degree of humidity the best place to store the instrument in is an air-tight receptacle along with a moisture-absorbing agent (e.g. silica gel).

EN

Swarobright coating

This complicated procedure reduces reflections and controls all color spectrums to provide the highest light transmission, best contrast, sharpest resolution and optimal color fidelity.

☀ Easy to Clean®

Non-stick effect thanks to Easy to Clean. Obvious cleaning advantage in the case of dirt such as water marks, insect repellents and tree resin.

Easy to Clean coating is not available in North America.

All data are typical values.

We reserve the right to make changes regarding design and delivery.

BA-643/3, 05/2007